



**SUBMITTAL DATA: FLEXX48HP230V1BH / FLEXX60AC230V1AO 48000 BTU/H Unitary Cooling Only Split System**

Job Name	Location	Date
Purchaser	Engineer	
Submitted To	For	
Unit Designation	Schedule No.	

<b>FLEXX48HP230V1BH</b>	<b>FLEXX60AC230V1AO</b>
-------------------------	-------------------------



**GENERAL FEATURES**

- High Efficiency DC Inverter Technology**
- Compact and Quiet 55 dB(A) Side Discharge Outdoor Unit**
- Zero Lot Line Design**
- Match with Gree or Competitive Indoor Unit**
- Designed for New Construction or Replacement Market**
- 24VAC Thermostat Compatible**
- 8 Speed Fan Motor**

**Cooling Range 40°F to 118°F**

**Acrylic Resin/Anti-Corrosion Fin Coating (Blue - 500 Hr Salt Spray Rating)**

**5 Year Limited Compressor & Parts Warranty (Residential Only)**

SPECIFICATIONS		FLEXX48HP230V1BH / FLEXX60AC230V1AO	
System Type		COOLING ONLY	
<b>SYSTEM PERFORMANCE</b>			
Cooling	Rated Capacity @ 95°F	Btu/h	48000
	Min-Max Capacity	Btu/h	34000 - 48000
SEER / EER		18 / 11	
Energy Star®		NO	
Cooling Temperature Range		°F	40 - 118
<b>INDOOR UNIT</b>		<b>FLEXX48HP230V1BH</b>	
Fan Motor Output Power		W	746
Fan Motor FLA		amps	5
Air Flow (Min - Max)		CFM	1380
Static Pressure (Rated / Maximum)		In w.c	0.2 / 1.0
Sound Pressure Level		dB(A)	50
Dehumidification		pt/hr	9.94
Condensate Drain Size (OD)		in	3 / 4
Unit Dimension (WxHxD)		in	24 3/4 x 57 x 21 1/4
Package Dimension (WxHxD)		in	27 5/16 x 59 3/8 x 26
Weight (Net / Gross)		lbs	202 / 218
Electric Heater (Optional)		kW	10, 15, 20
<b>OUTDOOR UNIT</b>		<b>FLEXX60AC230V1AO</b>	
Compressor Type		Inverter Rotary	
Compressor RLA		amps	19
Fan Motor Output Power		W	149
Fan Motor (2)		amps	1.5 Ea
Sound Pressure Level		dB(A)	58
Unit Dimension (WxHxD)		in	37 1/4 x 56 1/3 x 16 3/16
Package Dimension (WxHxD)		in	40 7/8 x 62 1/4 x 17 1/4
Weight (Net / Gross)		lbs	262.4 / 288.8
Refrigerant Charge - R410A		oz	194
Coil Type (Blue Fin)		Copper Tube / Aluminum Fin	
<b>REFRIGERANT PIPING</b>			
Line Set Size (Liquid - Gas)		in	3/8 - 3/4
Pre-Charge Length		ft	31
Additional Charge		oz/ft	0.32
Pipe Length (Min - Max)		ft	10 - 100
Max. Pipe Elevation		ft	50
<b>ELECTRICAL</b>			
Power Supply (Voltage Operating Range)		208/230V / 1Ph / 60 Hz	
Outdoor Unit	Rated Current	amps	30
	MCA / MOCP	amps	35 / 45
Indoor Unit	Rated Current	amps	5
	MCA / MOCP	amps	8 / 15
Main Power Wire Size		AWG	Size Per Local Code
<b>LIMITED WARRANTY</b>		<b>5 Years Parts and Compressor - Residential</b>	

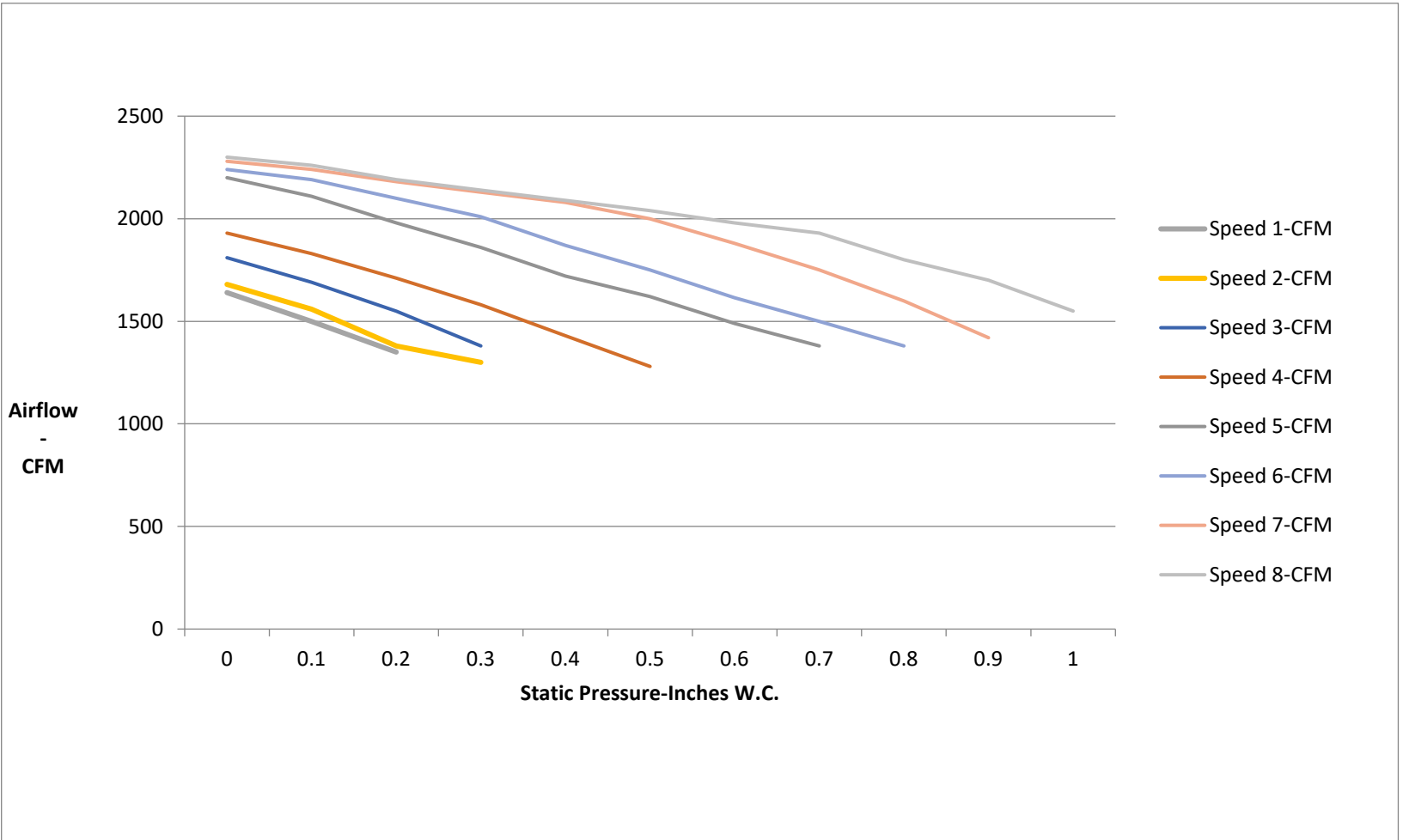

Static Pressure-Inches W.C.	0	0.1	0.15	0.2	0.3	0.4	0.5	0.6	0.7	0.8	0.9	1.0
Speed 1-CFM	1640	1500	1450	1350								
Speed 2-CFM	1680	1560	1500	1380	1300							
Speed 3-CFM	1810	1690	1620	1550	1380							
Speed 4-CFM	1930	1830	1770	1710	1580	1430	1280					
Speed 5-CFM	2200	2110	2040	1980	1860	1720	1620	1490	1380			
Speed 6-CFM	2240	2190	2145	2100	2010	1870	1750	1615	1500	1380		
Speed 7-CFM	2280	2240	2200	2180	2130	2080	2000	1880	1750	1600	1420	
Speed 8-CFM	2300	2260	2220	2190	2140	2090	2040	1980	1930	1800	1700	1550

<b>COOLING PERFORMANCE</b>					
Outdoor Ambient Temperature (DB)		Return Air Temperature			
		80°F (DB)			
		TC (Btu/h)	SHR	EER	Power Input (W)
<b>MAX OUTPUT</b>	40°F	48000	72.5%	14.9	3220
	45°F	48000	74.2%	14.6	3290
	50°F	48000	73.0%	14.3	3360
	55°F	48000	73.8%	13.9	3460
	60°F	48000	74.0%	13.4	3590
	65°F	48000	73.0%	12.9	3710
	70°F	48000	74.5%	12.8	3760
	75°F	48000	72.8%	12.6	3810
	80°F	48000	73.4%	12.2	3940
	85°F	48900	72.5%	12.0	4060
	90°F	48900	74.7%	11.2	4360
	95°F	48900	73.0%	10.4	4680
	100°F	48900	73.8%	9.9	4960
	105°F	48000	72.0%	9.1	5260
	110°F	46000	73.9%	9.1	5060
	115°F	43500	74.0%	9.0	4820
118°F	36000	71.7%	8.1	4460	

**LEGEND:** W - Watts  
 DB - Dry Bulb  
 TC - Total Capacity  
 SHR - Sensible Heat Ratio

SYSTEM FEATURES	
Inverter Type	G10
Ultra Low Frequency Torque Control	Yes
Power Factor Correction	Yes
Compressor Type	Rotary
Basepan With Electric Heater	No
Indoor & Outdoor Fin Coating	Yes
Low Voltage Startup	Yes
Memory/Power Failure Recovery	Yes
Self Diagnosis	Yes
Smart Thermostat / 24V Thermostat Compatible	Yes
Wired Controller Interface	No
WiFi Included	No
Indoor Fan Type	Centrifugal
Multi Fan Speeds	8
Rated External Static Pressure	0.1
External Static Pressure (Min - Max)	0 - 1.0
Indoor Unit Display	No
Auxiliary Electrical Heater	Optional
Ventilation (Outdoor Air)	No

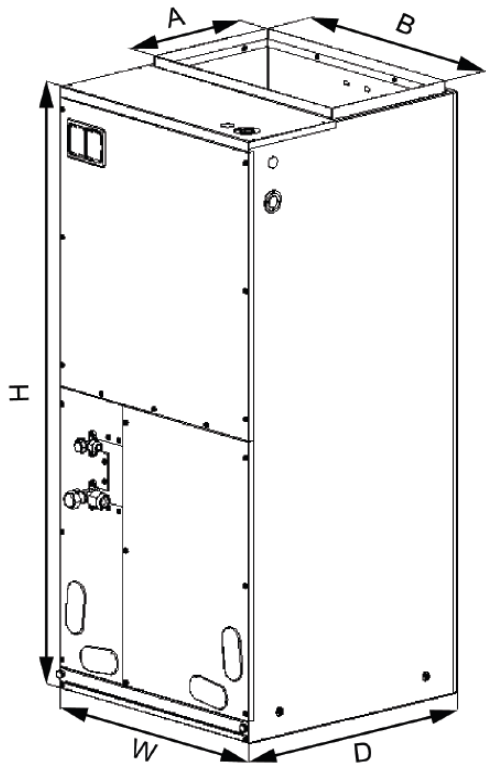

Dimensions	
A	11 5/8
B	20
H	57
W	24 3/4
D	21 1/4

Filter Size	
Supplied*	20 5/8 x 20 5/16 x 1/2
Suggested	20 5/8 x 20 5/16 x 1

\*Supplied filter is metal mesh

Clearances	
Front	> 24

Allow a minimum of 24" in front of the unit for service clearance. When installing in an area directly over a finished ceiling (such as an attic), an emergency drain pan is required directly under the unit. **See local and state codes for requirements.** When installing this unit in an area that may become wet, elevate the unit with a sturdy, non-porous material. In installations that may lead to physical damage (i.e. a garage) it is advised to install a protective barrier to prevent such damage. This air handler is designed for a complete supply and return ductwork system.

**Multi-Position Capabilities**

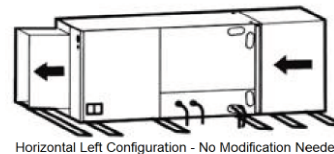
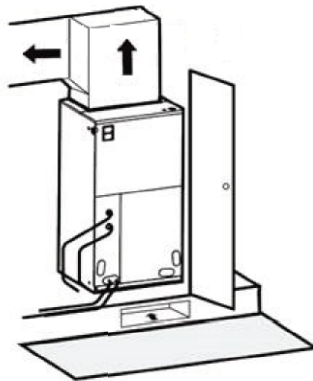

Horizontal Left Configuration - No Modification Needed

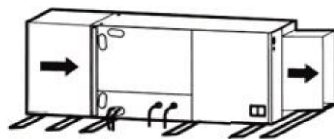

Horizontal Right Configuration - Must Relocate Drain Pan

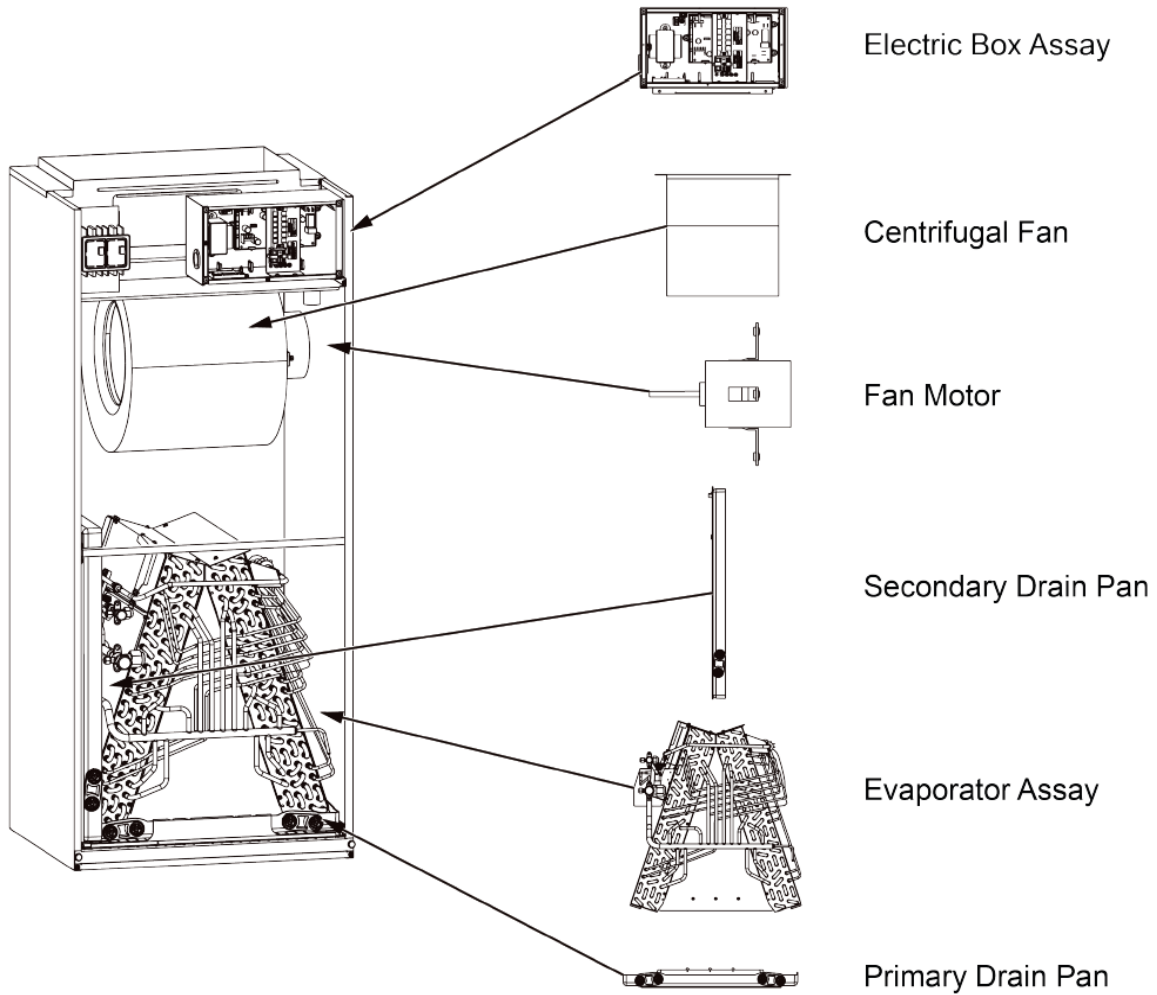

Model	Heat Kit Model	Electric Heat (kW)		Min. Circuit		Max.Fuse or Breaker	
		240V	208V	240V	208V	240V	208V
FLEXX48HP230V1BH	FLEXXHTR10KW	10	7.51	52	45	60	45
	FLEXXHTR15KW	15	11.25	52 & 26	45 & 22.6	60 & 30	45 & 25
	FLEXXHTR20KW	20	15.02	52 & 52	45 & 45	60 & 60	45 & 45
	21-4216-01	10	7.51	52	45	60	45
	21-4217-00	15	11.25	52 & 26	45 & 22.6	60 & 30	45 & 25
	21-4228-00	20	15.02	52 & 52	45 & 45	60 & 60	45 & 45



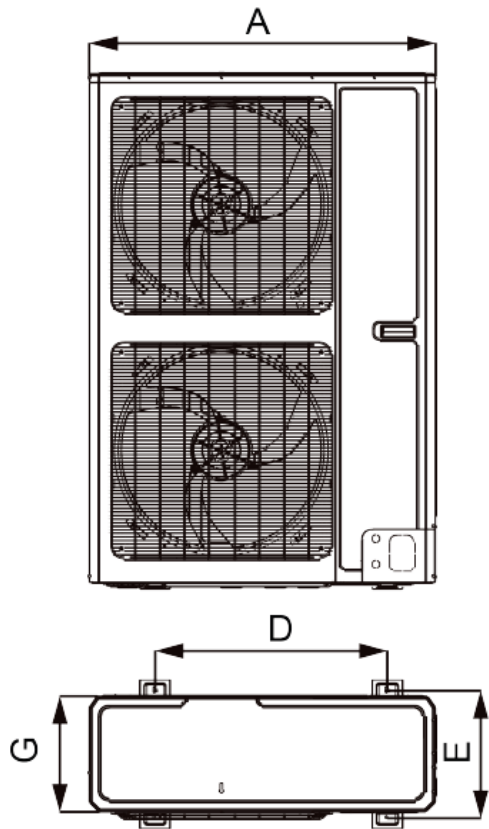

Dimensions	
A	37 1/4
B	16 3/16
C	56 1/3
D	24 7/8
E	13 7/8
G	12 5/8

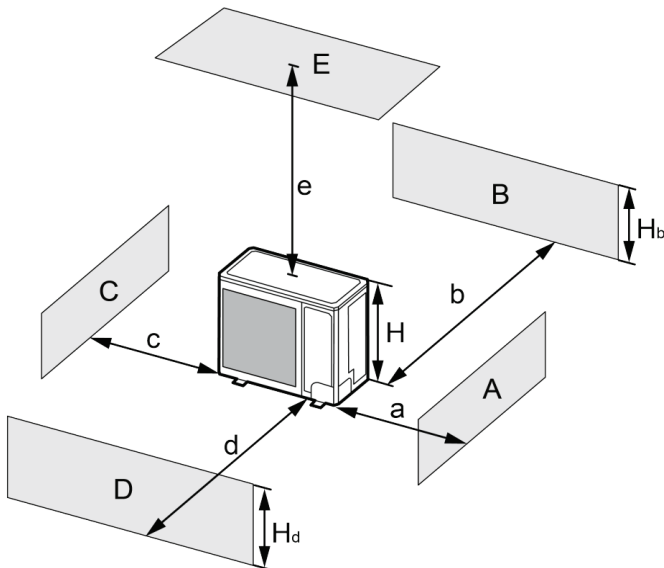

A~E	H <sub>b</sub>	H <sub>d</sub>	H	(in)				
				a	b	c	d	e
B	—	—	—	-	≥ 4	-	-	-
A,B,C,	—	—	—	≥ 12	≥ 4	≥ 4	-	-
B,E	—	—	—	-	≥ 4	-	-	≥ 40
A,B,C,E	—	—	—	≥ 12	≥ 6	≥ 6	-	≥ 40
D	—	—	—	-	-	-	≥ 40	-
D,E	—	—	—	-	-	-	≥ 40	≥ 40
B,D	H <sub>b</sub> < H <sub>d</sub>	H <sub>d</sub> > H	—	-	≥ 4	-	≥ 40	-
	H <sub>b</sub> > H <sub>d</sub>	H <sub>d</sub> < H	—	-	≥ 4	-	≥ 40	-
B,D,E	H <sub>b</sub> < H <sub>d</sub>	H <sub>b</sub> ≤ 1/2H	—	≥ 10	-	≥ 80	≥ 40	
		1/2H < H <sub>b</sub> ≤ H	—	≥ 10	-	≥ 80	≥ 40	
	H <sub>b</sub> > H							Prohibited
	H <sub>b</sub> > H <sub>d</sub>	H <sub>d</sub> ≤ 1/2H	—	≥ 4	-	≥ 80	≥ 40	
		1/2H < H <sub>d</sub> ≤ H	—	≥ 8	-	≥ 80	≥ 40	
H <sub>d</sub> > H							Prohibited	

Specifications are subject to change without notice. Manufacturer reserves the right to discontinue or modify specifications or designs without notice or without incurring obligations. All Rights reserved.