

**SUBMITTAL DATA: FLR09HP230V1BF****9000 BTU/H Floor/Ceiling Heat Pump System**

Job Name	Location	Date
Purchaser	Engineer	
Submitted To	For	
Unit Designation	Schedule No.	

**YT1F / XK19****FLR09HP230V1BF****3VIR09HP230V1AO****(Optional)****GENERAL FEATURES****AHRI Certificate: 207201626****High Efficiency DC Inverter Technology****Quiet Operation and Multi-Speed Fan****Floor Stand or Ceiling Mount****Multi-Directional Air Flow****Wireless Remote with LCD Display Included****XK19 Wired Controller Included****Low Ambient Cooling down to -20°F (Range -20°F to 122°F)****Low Ambient Heating down to -22°F (Range -22°F to 86°F)****Coil (Indoor and Outdoor) Copper Tube / Aluminum Fin\*****\* (Blue Fin) 500 Hrs Salt Spray Tested****5 Year Limited Compressor & Parts Warranty (Residential Only)**

## SPECIFICATIONS

## 3VIR09HP230V1AO / FLR09HP230V1BF

System Type		<b>HEAT PUMP</b>	
<b>SYSTEM PERFORMANCE</b>			
Cooling	Rated Capacity @ 95°F	Btu/h	9100
	Min-Max Capacity	Btu/h	2450 - 13300
Heating	Rated Capacity @ 47°F	Btu/h	11000
	Rated Capacity @ 17°F	Btu/h	6900
	Min-Max Capacity	Btu/h	2590 - 13300
SEER / EER		19.5 / 13.3	
HSPF / COP		11.2 / 3.75	
Energy Star®		YES	
Cooling Temperature Range		°F	-20 - 122
Heating Temperature Range		°F	-22 - 86
<b>INDOOR UNIT</b>		<b>FLR09HP230V1BF</b>	
Fan Motor Output Power		W	15
Fan Motor FLA		amps	0.9
Air Flow (Min - Max)		CFM	257 - 412
Sound Pressure Level (Cooling / Heating)		dB(A)	26 - 38
Dehumidification		pt/hr	1.7
Condensate Drain Size (OD)		in	11/16
Unit Dimension (WxHxD)		in	34 1/4 X 26 1/4 X 9 1/4
Package Dimension (WxHxD)		in	40 1/2 X 30 1/4 X 11 1/4
Weight (Net / Gross)		lbs	55 / 66.2
<b>OUTDOOR UNIT</b>		<b>3VIR09HP230V1AO</b>	
Compressor Type		G-10 / 1-Stage Inverter	
Compressor RLA		amps	6
Fan Motor Output Power		W	30
Fan Motor RLA		amps	0.4
Sound Pressure Level (Cooling / Heating)		dB(A)	52
Unit Dimension (WxHxD)		in	33 3/8 X 23 1/2 X 12 5/8
Package Dimension (WxHxD)		in	34 1/2 X 24 7/8 X 14 1/4
Weight (Net / Gross)		lbs	73.9/80.5
Refrigerant Charge - R410A		oz	36.3
Coil Type		Aluminum Fin / Copper Tube	
<b>REFRIGERANT PIPING</b>			
Line Set Size (Liquid - Gas)		in	1/4 - 3/8
Pre-Charge Length		ft	25
Pipe Length (Min - Max)		ft	10 / 49
Max. Pipe Elevation		ft	33
<b>ELECTRICAL</b>			
Power Supply (Voltage Operating Range)		208-230V / 1Ph / 60Hz	
Rated Current (Cooling / Heating)		amps	3 / 7.2
MCA / MOCP		amps	9 / 15
Main Power Wire Size		AWG	Size Per Local Code
Interconnecting Wire Size		AWG	14 / 4
<b>LIMITED WARRANTY</b>		<b>5 Years Parts and Compressor - Residential</b>	

**EXTENDED RATINGS**

**FLR09HP230V1BF**

COOLING PERFORMANCE						HEATING PERFORMANCE				
Outdoor Ambient Temperature (DB)		Return Air Temperature				Outdoor Ambient Temperature (DB)		Return Air Temperature		
		80°F (DB)						70°F (DB)		
		TC (Btu/h)	SHR	EER	Power Input (W)			TC (Btu/h)	COP	Power Input (W)
<b>MAX OUTPUT</b>	-13°F	5018.5	3482	2.55	576	<b>MAX OUTPUT</b>	-22°F	5260	1.22	1260
	-10°F	5248.57	3715	2.61	589		-20°F	5655	1.29	1289
	-5°F	5378.4	3841	2.59	609		-15°F	6312	1.42	1301
	0°F	5459	3958	2.57	622		-10°F	6529	1.46	1315
	5°F	5678	4145	2.62	635		-5°F	6715	1.48	1332
	10°F	5896	4304	2.62	660		0°F	9093	1.97	1356
	15°F	6005	4414	2.61	673		5°F	10492	2.23	1380
	20°F	6333	4686	2.66	699		10°F	11191	2.46	1332
	25°F	6551	4848	2.65	724		15°F	12170	2.70	1320
	30°F	6988	5206	2.69	762		17°F	12450	2.76	1320
	35°F	7315	5486	2.68	800		20°F	12590	2.93	1260
	40°F	7643	5732	2.71	826		25°F	12730	3.05	1224
	45°F	7970	6058	2.63	889		30°F	13010	3.14	1212
	50°F	8298	6265	2.52	965		35°F	13150	3.21	1200
	55°F	8844	6721	2.55	1016		40°F	13290	3.38	1152
	60°F	9390	7136	2.55	1079.5		45°F	13709	3.42	1176
	65°F	10045	7684	2.58	1143		47°F	13989	3.42	1200
	70°F	10482	8071	2.60	1181		50°F	14688	3.55	1212
	75°F	11028	8491	2.68	1207		55°F	15108	3.58	1236
	80°F	11464	8942	2.76	1219		60°F	16087	3.71	1272
	85°F	11574	8969	2.73	1245		65°F	15388	3.45	1308
	90°F	11901	9283	2.77	1257		70°F	14828	3.29	1320
	95°F	10918	8516	2.52	1270		75°F	13849	3.05	1332
	100°F	10372	8121	2.30	1320		80°F	13589	2.89	1380
105°F	9827	7714	2.1	1372	86°F	13148	2.71	1420		
110°F	9499	7504	1.97	1410						
115°F	9171	7245	1.84	1461						
120°F	8080	6423	1.61	1473						

**LEGEND:** W - Watts  
 DB - Dry Bulb  
 TC - Total Capacity  
 SHR - Sensible Heat Ratio  
 COP - Coefficient of Performance

## FEATURES & FUNCTIONS SUMMARY

3VIR09HP230V1AO / FLR09HP230V1BF

### SYSTEM FEATURES

Inverter Type	G10
Ultra Low Frequency Torque Control	Yes
Power Factor Correction	Yes
Compressor Type - Inverter	High Efficiency Rotary
Basepan With Electric Heater	Yes
Indoor & Outdoor Fin Coating (Blue Fin)	Yes
Intelligent Defrosting	Yes
Intelligent Preheating	Yes
Low Voltage Startup	Yes
Memory/Power Failure Recovery	Yes
Self Diagnosis	Yes
Wired Controller Interface	Yes
WiFi Included	No
Indoor Fan Type	Centrifugal
Multi Fan Speeds	4 Speeds
Indoor Unit Display	Yes
Auxiliary Electrical Heater	No
Ventilation (Outdoor Air)	No

### REMOTE CONTROLLER FUNCTIONS

Auto Mode	Yes
Auto Fan	Yes
Auto Swing - (Horizontal Auto Swing)	No
Auto Swing - (Vertical Auto Swing)	Yes
Clock	Yes
Dry Mode	Yes
Dry Anti-Mildew (X-Fan) Mode	Yes
Energy Saving Mode	Yes
Dirty Filter Alert	No
Fan Speed Control (4 Speeds)	Yes
I Feel Function	Yes
Privacy Lock	Yes
Quiet Mode	Yes
Room Temperature Display	No
Sleep Mode (Normal Sleep)	Yes
4 Sleep Mode Options	No
Timer Mode	Yes
Turbo Mode	Yes
Display On/Off Control	Yes
Freeze Guard Mode	Yes
Power Failure Mode	Yes

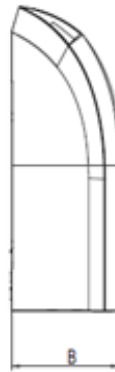
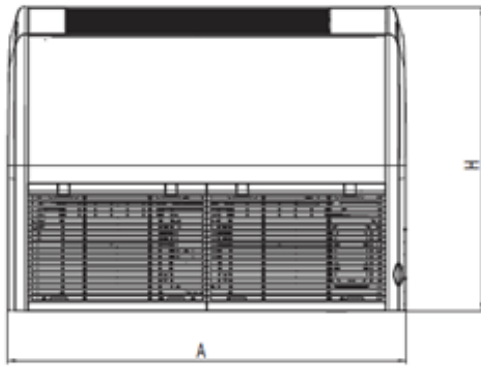

Dimensions	
A	34 1/4
B	9 1/4
C	32
D	12 1/2
H	26 1/4

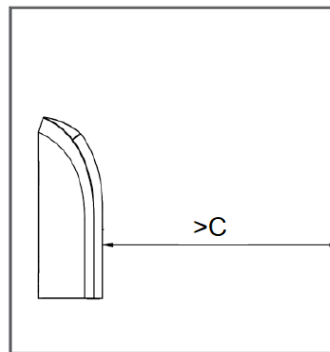
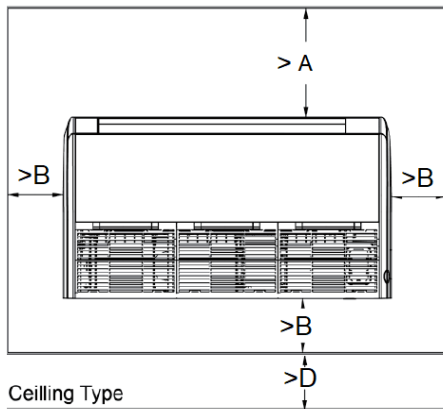
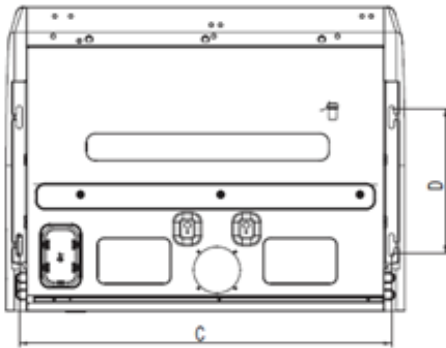

Dimensions	
A	60
B	12
C	39
D	6
E	90

Ceiling Type

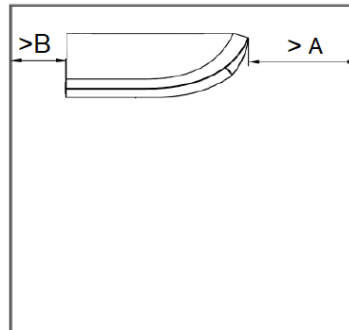
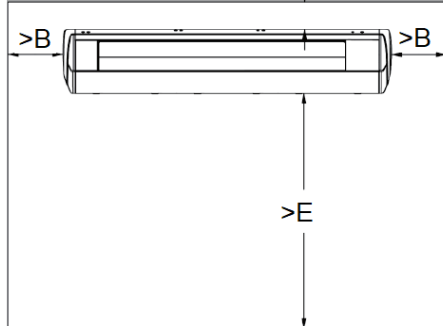

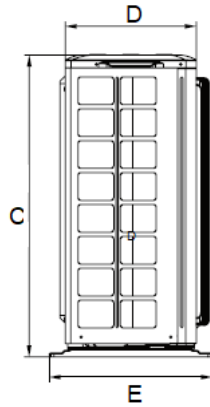
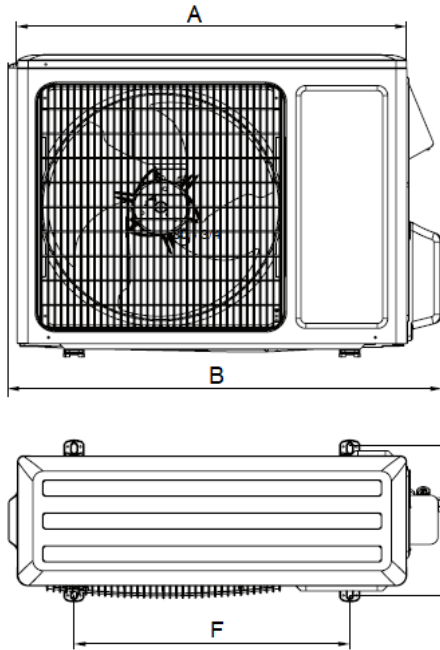

Dimensions	
A	30 3/4
B	33 3/8
C	23 1/2
D	10 1/8
E	12 5/8
F	21 5/16
G	11 5/16

Unit: inch

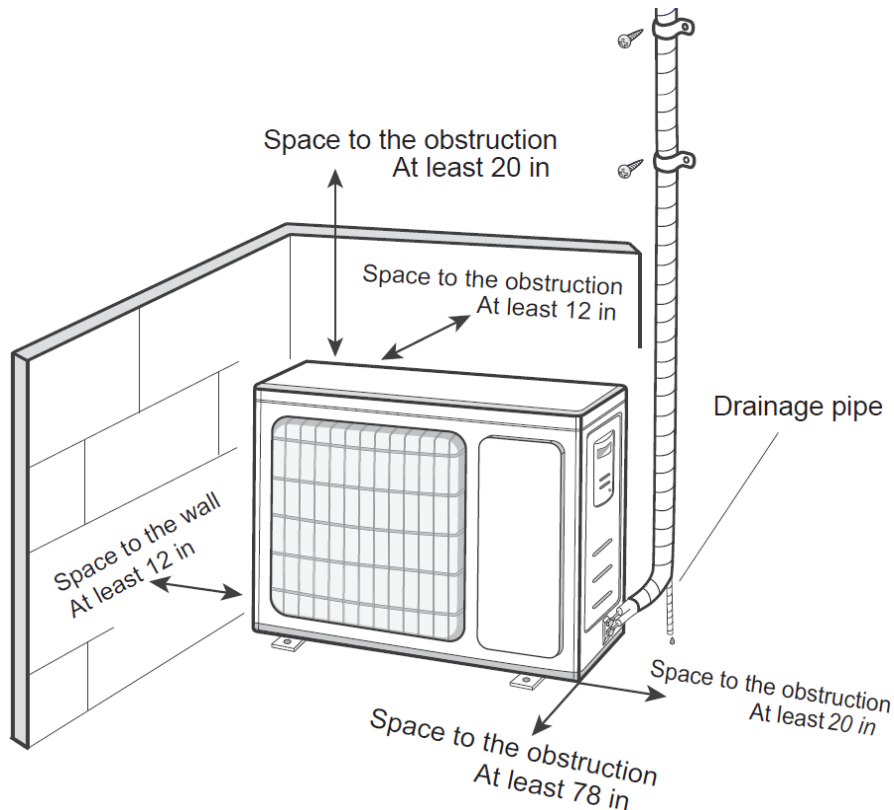

Specifications are subject to change without notice. Manufacturer reserves the right to discontinue or modify specifications or designs without notice or without incurring obligations. All Rights reserved.