



SUBMITTAL DATA

3VIR18HP230V1AH & BH¹ for Use with Multi GEN2 and Multi+ Ultra
18000 BTU/H Wall Mounted Unit

Job Name	Location	Date
Purchaser	Engineer	
Submitted to	For	
Unit Designation	Schedule No.	

 <p>YAP1F7F</p>	 <p>3VIR18HP230V1AH & BH¹</p>	 <p>XE71 (Optional)</p>
--	--	--

GENERAL FEATURES

- High Efficiency DC Inverter Technology
- Compact and Quiet Design
- Auto-Clean Function on Indoor Unit
- Wireless Remote with LCD Display
- Wired Controller Options
- Wi-Fi Included (Factory Installed)
- Low Ambient Cooling Based on Outdoor Unit Performance
- Low Ambient Heating Based on Outdoor Unit Performance
- Coil (Indoor and Outdoor) Copper Tube / Aluminum Fin
- Blue Colored Fin - 500 Hrs Salt Spray Tested

SPECIFICATIONS, FEATURES & FUNCTION SUMMARY

SPECIFICATIONS		3VIR18HP230V1AH & BH ¹		FEATURES & FUNCTIONS SUMMARY		3VIR18HP230V1AH & BH ¹	
System Type		HEAT PUMP					
SYSTEM PERFORMANCE				SYSTEM FEATURES			
Cooling	Nominal	Btu/h	18000	Wired Controller Interface (XE71)	Yes		
	Capacity @95°F	Btu/h		WiFi Included	Yes		
Heating	Nominal	Btu/h	18000	NEW! Easy Service Access	Yes		
	Capacity @5°F	Btu/h		Indoor Fan Type	Crossflow		
	Capacity @17°F	Btu/h		Multi Fan Speeds	7 Speeds		
	Capacity @47°F	W		Indoor Unit Display	Yes		
SEER2				Auxiliary Electrical Heater	No		
EER2				Ventilation (Outdoor Air)	No		
HSPF2				REMOTE CONTROLLER FUNCTIONS			
COP @5°F	System Performance Based on the Connected Outdoor Unit Performance			NEW! Auto Clean	Yes		
COP @47°F				Auto Mode	Yes		
Cooling Temperature Range	°F			Auto Fan	Yes		
Heating Temperature Range	°F			Auto Swing (Horizontal Auto Swing)	Yes		
Refrigerant Type	R410A			Auto Swing - 180° (Vertical Auto Swing)	Yes		
INDOOR UNIT		3VIR18HP230V1AH & BH¹		Clock	Yes		
Air flow (Min-Max)	CFM	283 - 618		Dry Mode	Yes		
Sound Pressure Level (Min - Max)	dB(A)	29 - 49		Dry Anti-Mildew (X-Fan) Mode	Yes		
Dehumidification	pt/hr	3.80		Energy Saving Mode	Yes		
External Dimensions (WxHxD)	in	38-11/16 x 12-1/4 x 8-3/4		Dirty Filter Alert	No		
Package Dimension (W x H x D)	in	41-1/8 x 15-3/16 x 11-3/4		Fan Speed Control (7 Speeds)	Yes		
Net Weight	lbs	28.7		I Feel Function	Yes		
Gross Weight	lbs	35.3		Privacy Lock	Yes		
REFRIGERANT PIPING				Quiet Mode	Yes		
Line Set Sized by the Indoor Unit (Liquid - Gas) - Flared Connections	in	1/4 - 5/8		Room Temperature Display	No		
ELECTRICAL				Sleep Mode	Yes		
Power Supply	208-230V / 1Ph / 60Hz (Powered by the Outdoor Unit)			3 Sleep Mode Options	Yes		
				Timer Mode	Yes		
				Turbo Mode	Yes		
				Display On/Off Control	Yes		
				Freeze Guard Mode	Yes		
				Power Failure Mode	Yes		

¹AH = MATT FINISH; BH = SMOOTH FINISH

DIMENSIONS & CLEARANCES

INDOOR UNIT

Unit: inch

3VIR18HP230V1AH & BH ¹	
DIMENSIONS	
W	38-21/32
H	12-1/4
D	8-45/64
W1	4-53/64
W2	27-55/64
W3	5-63/64

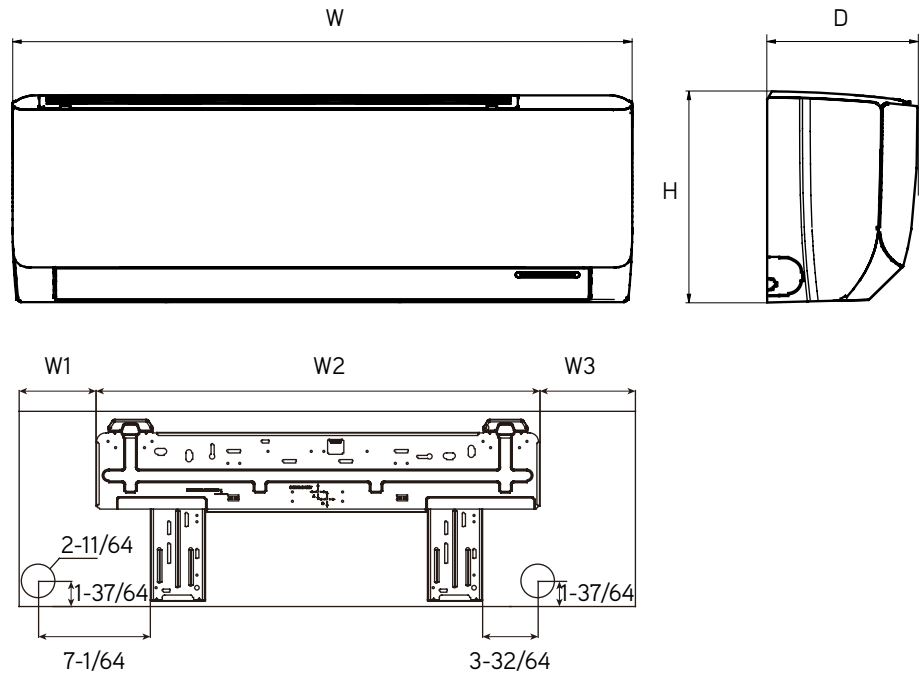

INDOOR UNIT

Minimum clearance

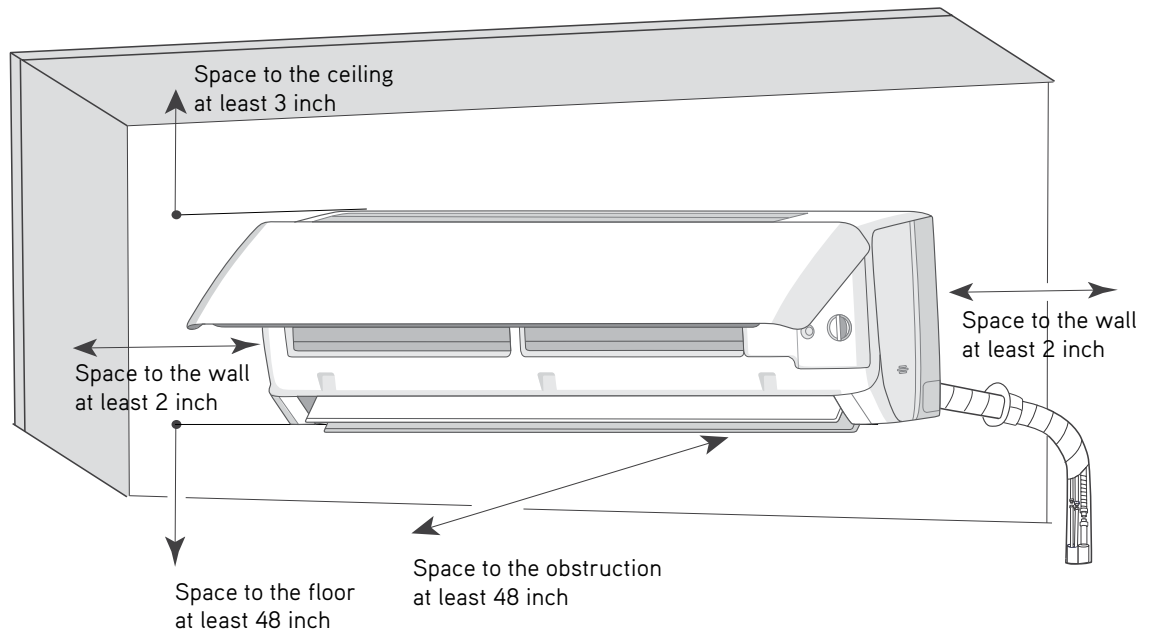

Specifications are subject to change without notice. Manufacturer reserves the right to discontinue or modify specifications or designs without notice or without incurring obligations. All Rights reserved.

GREECOMFORT.COM/SYSTEM-DOCUMENTATION